

# QUANTUM QSS8

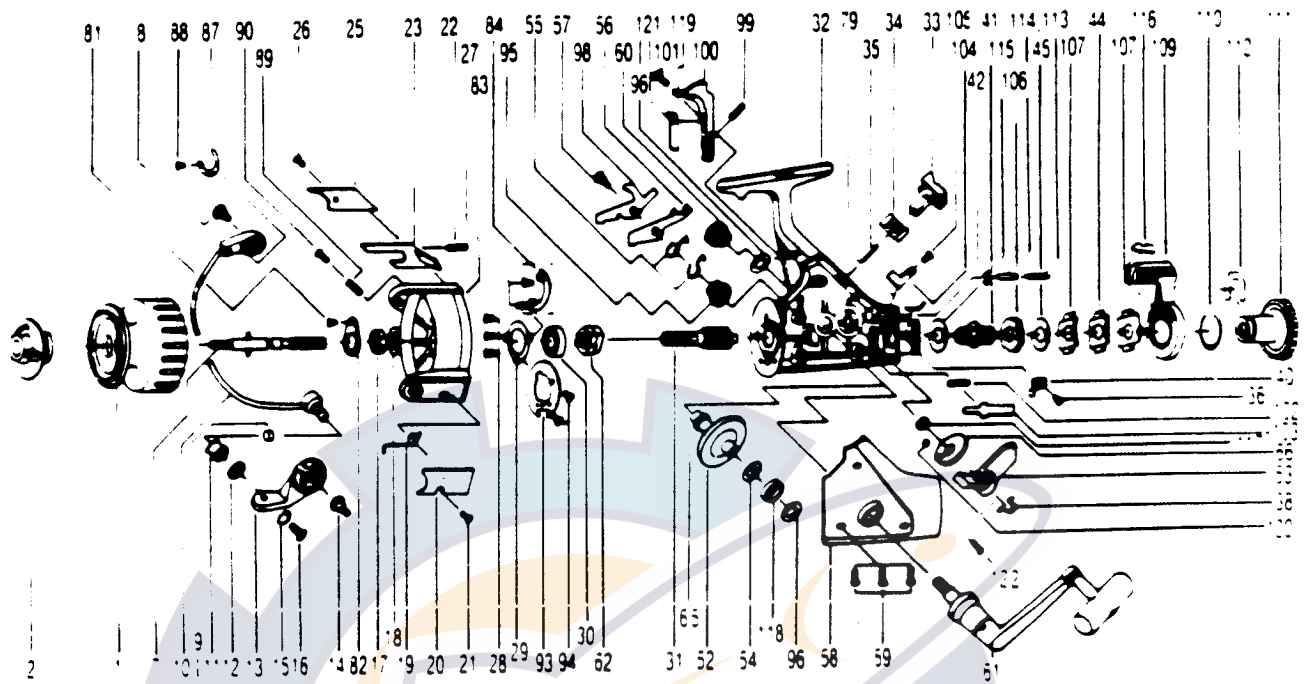

KEY PART NO. NO.	DESCRIPTION	PRICE	KEY PART NO. NO.	DESCRIPTION	PRICE
1	US321 SPOOL ASSY	12.04	59	US057 BODY COVER SCREW	.85
2	US050 DRAG KNOB ASSY.	5.73	60	RS073 HANDLE SCREW CAP	1.14
7	US315 MAIN SHAFT ASSY	8.60	61	US318 HANDLE ASSY	13.12
8	US048 BAIL HOLDER SCREW	1.72	62	US060 RATCHET GEAR	4.53
9	SS016 LINE ROLLER BUSHING	1.66	65	US001 O/S GEAR PINION	2.00
10	RS347 BAIL ARM ASSY	6.13	66	US053 OSCILLATING GEAR	1.83
11	US004 LINE ROLLER	1.90	79	US005 BACK CLAW	.98
12	US017 BAIL COLLAR	1.32	81	SS058 ROTOR NUT LOCK SCREW	.58
13	US007 ARM LEVER	1.72	82	SS088 ROTOR NUT LOCK	1.43
14	US051 ARM LEVER SCREW	1.72	83	US182 KICK LEVER GUIDE SCR	.98
15	US102 BAIL WASHER	.46	84	US082 KICK LEVER GUIDE	1.61
16	US108 BAIL SCREW	.85	87	US130 BAIL HOLDER SPRING	1.32
17	US006 ROTOR NUT	1.72	88	US131 BAIL HOLDER SPR SCR	.52
18	US065 ROTOR RETAINER WASHE	.92	89	US132 SPOOL LOCK PIN SPR.	.58
19	US022 BAIL SPRING	1.09	90	US133 SPOOL LOCK PIN	1.14
20	US087 BAIL SPR. COVER	1.27	93	US134 KICK LEVER LOCK PLT.	3.61
21	US085 BAIL SPR. CVR. SCR.	.58	94	US135 KICK LVR LCK PLT SCR	.58
22	US049 KICK LEVER SPRING	.46	95	US136 ANTI-REVERSE GEAR	1.14
23	US019 KICK LEVER	1.66	96	US137 BALL BEARING CVR WSH	.75
25	US024 KICK LEVER COVER	1.27	98	US138 ANTI-REVERSE CLAW B	1.78
26	RS037 KICK LVR. CVR. SCR.	.58	99	US139 A/R ACTUATOR SPR.	.58
27	US009 ROTOR	11.46	100	US140 A/R ACTUATOR	1.14
28	RS080 BEARING PLATE SCREW	1.14	101	US141 A/R ACTUATOR SCR.	.58
29	US040 BEARING PLATE	1.43	102	US142 MAIN SHAFT STOP. SP	.58
30	US028 BALL BEARING	9.12	103	US143 MAIN SHAFT STOPPER	1.43
31	US011 PINION GEAR	10.26	104	US144 STOPPER PLATE	1.14
32	US301 BODY ASSY	13.46	105	RS145 STOPPER PLATE SCR.	.58
33	US059 ANTI-REVERSE LEVER	1.03	106	US146 SL. HOLDER RATCHET	2.00
34	US090 A/R LEVER PLATE SCR.	1.27	107	US147 DRAG SPR. WASHER A	2.87
35	NS091 A/R LEVER PIN	.29	108	US148 BAIL CLICK ACTUATOR	3.44
36	US067 CLICK CLAW SCREW	.58	110	US149 BAIT DRAG RING	.98
38	US083 OSC. SLIDER STOPPER	3.44	111	US150 BAIT CLICK DRAG KN.	2.00
40	US068 CLICK CLAW	.85	112	US151 BT CLICK DRAG KN RE	1.43
41	US104 SLIDER HOLDER	1.27	113	US152 BT CLICK LOCK SH SP	.58
42	US046 DRAG WASHER "C"	.75	114	US153 BT CLICK LOCK SHAFT	1.27
44	US030 DRAG WASHER "A"	1.72	115	US154 "E" CLIP	.29
45	US039 DRAG WASHER "B"	1.27	116	US155 BAIT INSERT	2.12
52	US012 DRIVE GEAR	14.85	117	US156 O/S GEAR BUSHING	1.27
53	US025 OSCILLATING SLIDER	3.39	118	US157 BALL BEARING	9.12
54	US026 DRIVE GEAR ADJ. WSHR	.46	119	US158 A/R ACT CV OSC BUSH	.85
55	US061 A/R CLAW SPRING	.92	120	US159 O/S GEAR BOSS BUSH	1.27
56	US063 A/R CLAW	1.90	121	US160 A/R ACTUATOR COVER	1.32
57	US089 A/R CLAW SCREW	.92	122	RS161 O/S STOPPER SCREW	.58
58	US323 BODY COVER ASSY	8.88			

Prices subject to change without notice. Prices do not include postage and handling.

**PLEASE ORDER BY PART NUMBER**

Rev. 11/90

Zebco Division Brunswick Corporation, Box 270, Tulsa, OK 74101 USA 918-836-5581

